

# Pro Head Fitment & Assembly Details

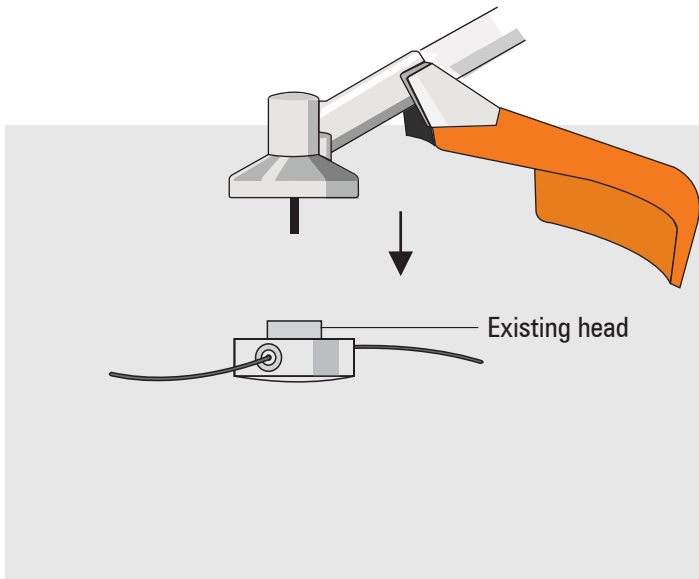

## Step 1



## Step 2

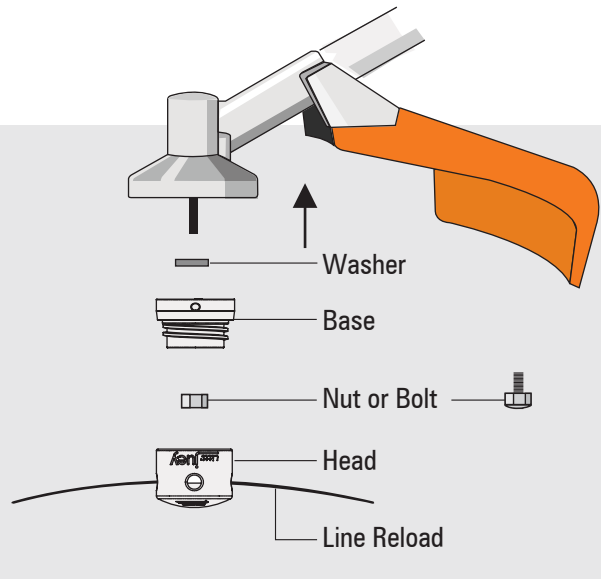

1. Remove original head from weedcutter (refer to your owners manual for details).

2. If required place washer in Littl' Juey base as illustrated.

3. Attach the Littl' Juey base onto your weedcutter with nut or bolt (both of these are included with your machine blade kit)

4. Tighten nut or bolt until secure.

5. Attach the Littl' Juey head with the Littl' Juey Line Reload in the holes provided and tighten.



Please Note:  
Safety equipment  
must be worn  
when operating  
your weedcutter.

**Littl' Juey**  
[www.littljuey.com](http://www.littljuey.com)