

Straight Shaft Head Fitment & Assembly Details

Step 1

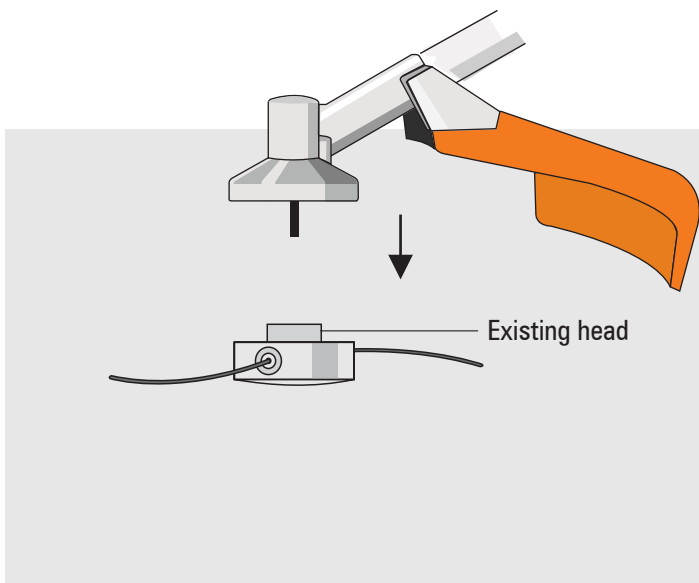

Step 2

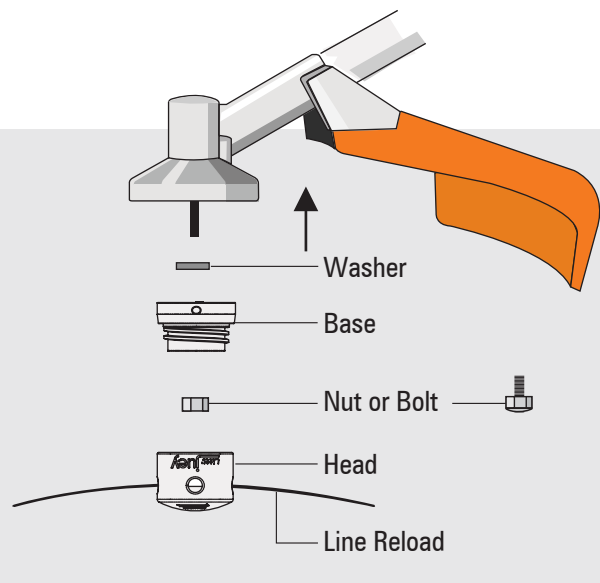

1. Remove original head from weedcutter (refer to your owners manual for details).

2. If required place washer in Littl' Juey base as illustrated.

3. Attach the Littl' Juey base onto your weedcutter with nut or bolt (both of these are included with your machine blade kit)

4. Tighten nut or bolt until secure.

5. Attach the Littl' Juey head with the Littl' Juey Line Reload in the holes provided and tighten.

Recommended
Nylon:

- Littl' Juey 2.4mm
Standard Line Reload



Please Note:
Safety equipment
must be worn
when operating
your weedcutter.

Littl' juey
www.littljuey.com